

TITAN AF

Installation instructions

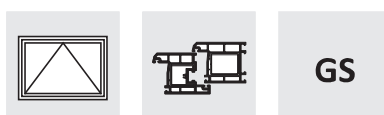

1-sash square tilt

PVC

basic security

centre handle pos. (variable)

Hinge side TITAN

surface TS

backset 15 mm

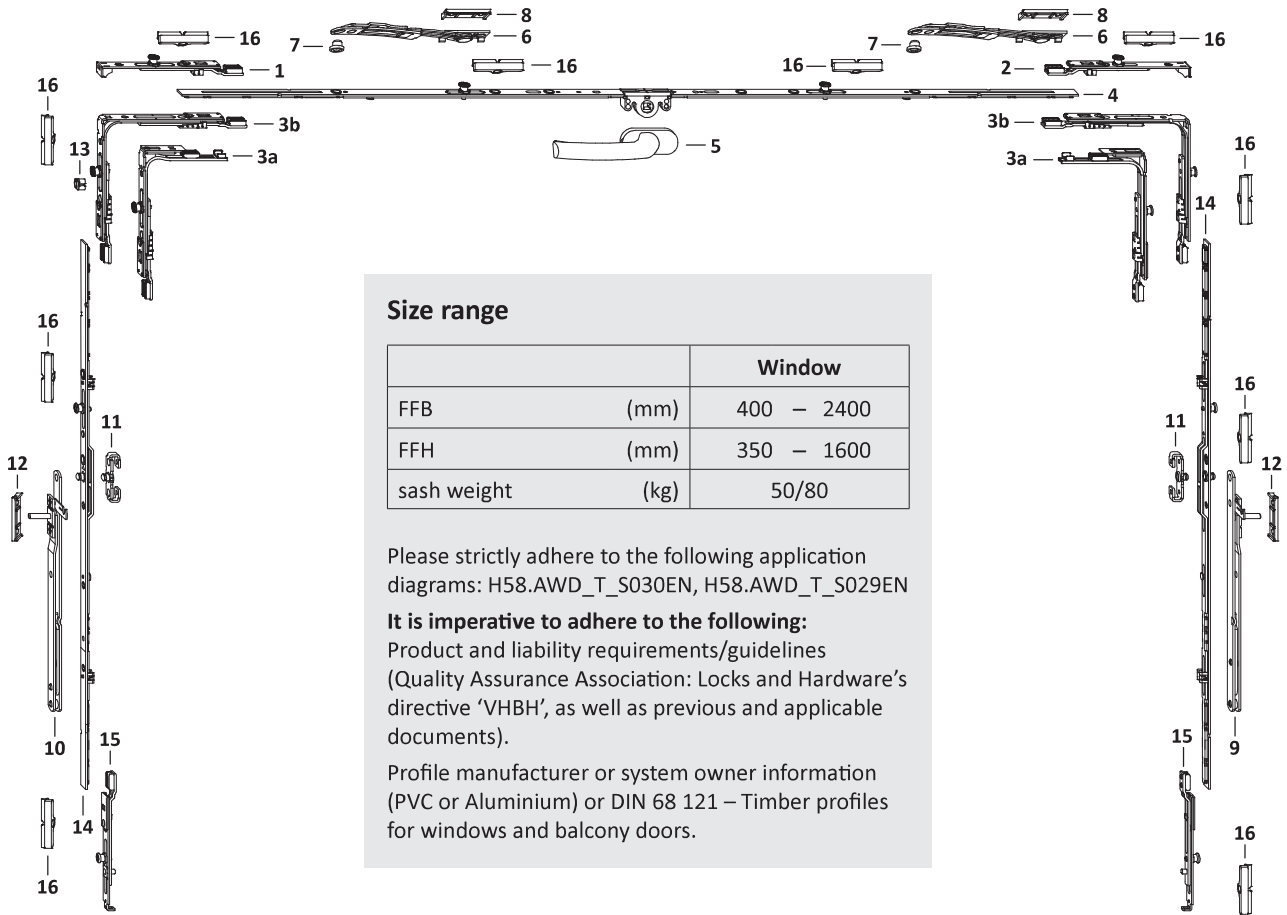
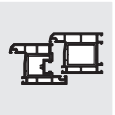
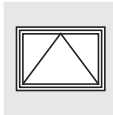

Size range

		Window
FFB	(mm)	400 – 2400
FFH	(mm)	350 – 1600
sash weight	(kg)	50/80

Please strictly adhere to the following application diagrams: H58.AWD_T_S030EN, H58.AWD_T_S029EN

It is imperative to adhere to the following:

Product and liability requirements/guidelines (Quality Assurance Association: Locks and Hardware's directive 'VHBH', as well as previous and applicable documents).

Profile manufacturer or system owner information (PVC or Aluminium) or DIN 68 121 – Timber profiles for windows and balcony doors.

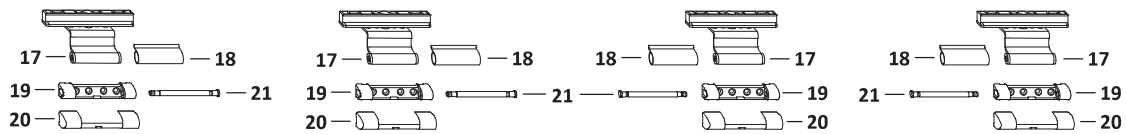

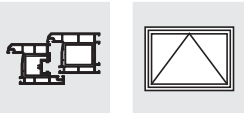

List of fittings
1-sash square tilt
PVC GM hinge side TITAN

TITAN AF

GS

Pos.	Description	Part number	QTY	FFB	FFH	Dimension G	Frame Parts Pos. 16
1	locking bolt AF VS 180° 1RS	TESC2020-...	1	601 – 2400	350 – 800		1
2	locking bolt AF tilt 90° 1RS	TESC2010-...	1	601 – 2400	350 – 800		1
3a	corner drive AF VSO narrow 1RS	TEUL4020-...	2	400 – 600	440 – 1600		2
3b	corner drive AF VSO 1RS	TEUL4010-...		601 – 2400	801 – 1600		2
4	gear 15 AF sz 60	TGMK4020-...	1	400 – 800		200 – 400	
	gear 15 AF sz 80 1RS	TGMK4040-...		801 – 1200		400 – 600	1
	gear 15 AF sz 120 1RS	TGMK4050-...		1201 – 1600		600 – 800	1
	gear 15 AF sz 160 2RS 70	TGMK4170-...		1601 – 2000		800 – 1000	2
	gear 15 AF sz 200 2RS	TGMK4080-...		2001 – 2400		1000 – 1200	2
5	handle Globe	Ref. EBS, ZHGS	1	400 – 2400			
6	telescopic tilt only stay	TSKF0020-...	1	400 – 800			
			2	801 – 2400			
7	lock.bolt f.rais.ring facepl.	TFZB0050-...	1	400 – 800			
			2	801 – 2400			
8	packer RB/FPS A....	Ref. PDB, FRUP02	1	400 – 800			
			2	801 – 2400			
9	tilt only safety stay 25 sz 1 rh.	ASFP0031-...	1	400 – 600	440 – 590		
	tilt only safety stay 25 sz 2 rh.	ASFP0041-...			591 – 800		
	tilt only safety stay 25 sz 1 rh.	ASFP0031-...			801 – 1000		
	tilt only safety stay 25 sz 2 rh.	ASFP0041-...		1001 – 1600			
	tilt only safety stay 25 sz 1 rh.	ASFP0031-...		601 – 2400	350 – 500		
	tilt only safety stay 25 sz 2 rh.	ASFP0041-...			501 – 800		
	tilt only safety stay 25 sz 1 rh.	ASFP0031-...			801 – 1000		
tilt only safety stay 25 sz 2 rh.	ASFP0041-...	1001 – 1600					
10	tilt only safety stay 25 sz 1 lh.	ASFP0032-...	1	400 – 600	440 – 590		
	tilt only safety stay 25 sz 2 lh.	ASFP0042-...			591 – 800		
	tilt only safety stay 25 sz 1 lh.	ASFP0032-...			801 – 1000		
	tilt only safety stay 25 sz 2 lh.	ASFP0042-...		1001 – 1600			
	tilt only safety stay 25 sz 1 lh.	ASFP0032-...		601 – 2400	350 – 500		
	tilt only safety stay 25 sz 2 lh.	ASFP0042-...			501 – 800		
	tilt only safety stay 25 sz 1 lh.	ASFP0032-...			801 – 1000		
tilt only safety stay 25 sz 2 lh.	ASFP0042-...	1001 – 1600					
11	fixing claw UGRP	ZFFP0010-...	2		350 – 800		
12	packer RB/FPS A....	Ref. PDB, FRUP02	2		350 – 1600		
13	travel restrictor	TFHB0010-...	1		440 – 1600		
14	linkage FPS/ZZ 1RS (200 mm cutting above)	TZZZ0040-...	2		801 – 1300		2
	linkage FPS/ZZ 1RS				1301 – 1600		
15	locking bolt AF VSU/K 1RS	TESC3020-...	2		1301 – 1600		2
16	striker plate S 56 A....	Ref. PDB, TRSM					

Hinge side turning points								
Pos.	Description	Part number	surface TS	RAL9016	RAL8022	QTY - FFB		
						400 – 800	801 – 1800	1801 – 2400
17	tilt sash hinge PVC	Ref. PDB, TBKF				2	3	4
18	cover cap W PVC			TKWB0010- 004...	TKWB0010- 012...	2	3	4
19	top hinge DH PVC	Ref. PDB, TBSL61				2	3	4
20	cover cap S			TKSL0020- 004...	TKSL0020- 012...	2	3	4
21	top hinge pin Poly	TBSB6020- 1...				2	3	4

10

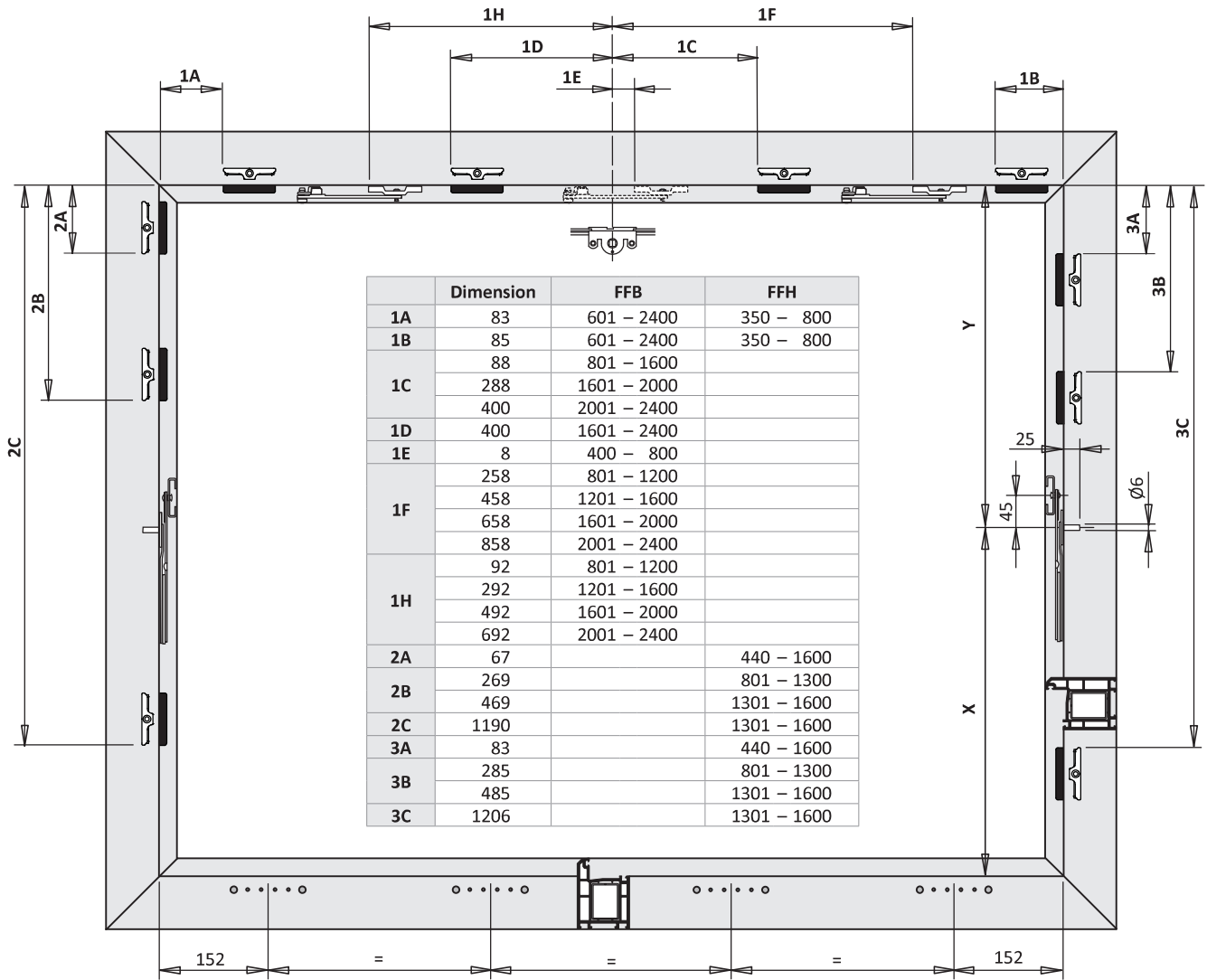
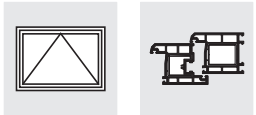

Dimensions in mm

All striker positions are frame rebate dimensions on assembled frames. Airgap 12⁺¹ mm.

RFB = FFB + 24 mm

RFH = FFH + 24 mm

50 kg	Dim.	FFB	FFH	ASFP	Opening width – arresting position	Opening angle – cleaning position
X	230	601 – 2400	350 – 500	Gr.1	278 – 385	ca. 78°
	370		501 – 800	Gr.2	238 – 370	ca. 80°
Y	272	400 – 600	440 – 590	Gr.1	400 – 319	95° – 53°
			591 – 800	Gr.2	298 – 258	87° – 53°
			801 – 1000	Gr.1	351 – 305	43° – 30°
			1001 – 1300	Gr.2	285 – 253	47° – 32°
	120	601 – 2400	1301 – 1600	Gr.2	319 – 281	40° – 29°
			350 – 500	Gr.1	256 – 235	71° – 45°
			501 – 800	Gr.2	220 – 205	72° – 41°
			801 – 1000	Gr.1	351 – 305	43° – 30°
			1001 – 1300	Gr.2	285 – 253	47° – 32°
			1301 – 1600	Gr.2	319 – 281	40° – 29°

