



# Lock Cylinders Catalogue

**Lock Cylinders**

Euro Profile Cylinders

Euro Thumb Turn Cylinders

Euro Half Cylinders

Euro Half Thumb Turn Cylinders

Snib Key

Accessories

2

7

10

12

14

15

**Rosette / Escutcheon**

Round

Square

17

21

## Siegware Euro Profile Cylinder

Euro profile full cylinder with 6 pin locking system. The body is made from nickel plated solid brass. All pins are made of solid brass and include security driver pins. These cylinders also include antidrill inserts. Tested to 200,000 cycles and compliant with the EN1303:2005.

All cylinders include 3 brass keys and 1 fixing screw.

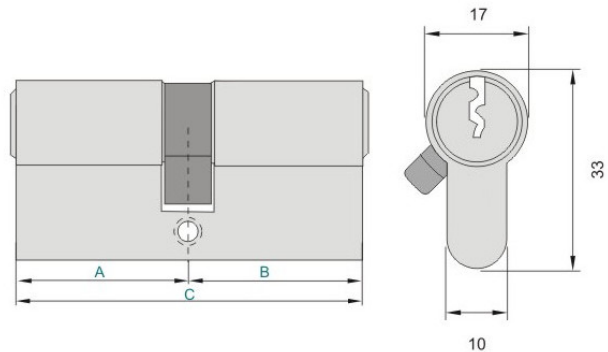

Product Code	Size (A / B)	Combination	Packaging unit
SWPZ3535A	35/35	A	10
SWPZ3535B	35/35	B	10
SWPZ3535C	35/35	C	10
SWPZ3535D	35/35	D	10
SWPZ3535E	35/35	E	10
SWPZ3535F	35/35	F	10
SWPZ3540A	35/40	A	10
SWPZ3540B	35/40	B	10
SWPZ4040A	40/40	A	10
SWPZ4040B	40/40	B	10
SWPZ4040C	40/40	C	10
SWPZ4040D	40/40	D	10
SWPZ4040E	40/40	E	10
SWPZ4040F	40/40	F	10

\*Note: Combinations are consistent between all Siegware Euro Cylinders, Half Cylinders, and Thumb Turn Cylinders.



Catalogue not up to date?  
Scan the QR or [click here](#)  
to view the latest version

[Click to jump back to top](#)

## Siegware Euro Profile Cylinder - Continue

Euro profile full cylinder with 6 pin locking system. The body is made from nickel plated solid brass. All pins are made of solid brass and include security driver pins. These cylinders also include antidrill inserts. Tested to 200,000 cycles and compliant with the EN1303:2005.

All cylinders include 3 brass keys and 1 fixing screw.

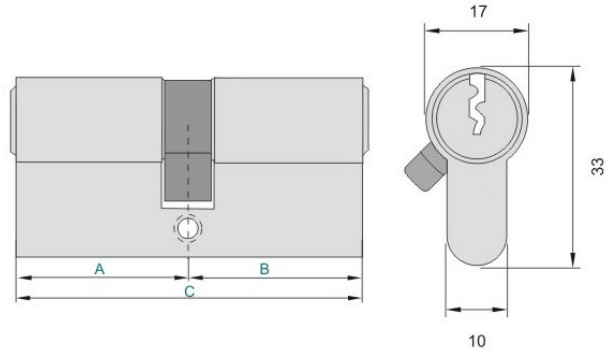

Product Code	Size (A / B)	Combination	Packaging unit
SWPZ4060A	40/60	A	10
SWPZ4060B	40/60	B	10
SWPZ4060C	40/60	C	10
SWPZ4545A	45/45	A	10
SWPZ4545B	45/45	B	10
SWPZ4545C	45/45	C	10
SWPZ4545D	45/45	D	10
SWPZ4545E	45/45	E	10
SWPZ4545F	45/45	F	10
SWPZ4550A	45/50	A	10
SWPZ4550B	45/50	B	10
SWPZ4550C	45/50	C	10
SWPZ4550D	45/50	D	10
SWPZ4550E	45/50	E	10
SWPZ4550F	45/50	F	10
SWPZ5050A	50/50	A	10
SWPZ5050B	50/50	B	10
SWPZ5050C	50/50	C	10
SWPZ5050D	50/50	D	10
SWPZ5050E	50/50	E	10

\*Note: Combinations are consistent between all Siegware Euro Cylinders, Half Cylinders, and Thumb Turn Cylinders.



**Catalogue not up to date?**  
Scan the QR or [click here](#)  
to view the latest version

[Click to jump back to top](#)

## Siegware Euro Profile Cylinder - Continue

Euro profile full cylinder with 6 pin locking system. The body is made from nickel plated solid brass. All pins are made of solid brass and include security driver pins. These cylinders also include antidrill inserts. Tested to 200,000 cycles and compliant with the EN1303:2005.

All cylinders include 3 brass keys and 1 fixing screw.

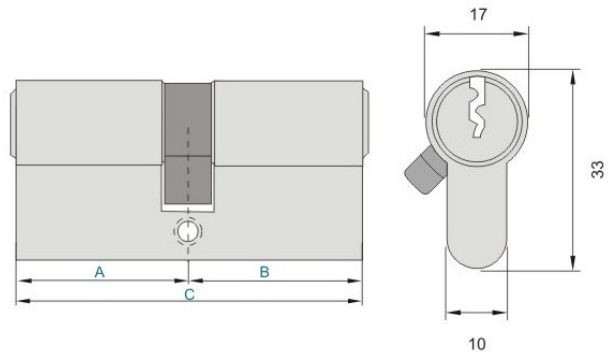

Product Code	Size (A / B)	Combination	Packaging unit
SWPZ5050F	50/50	F	10
SWPZ5555A	55/55	A	10
SWPZ5555B	55/55	B	10
SWPZ5555C	55/55	C	10
SWPZ5555D	55/55	D	10
SWPZ5555E	55/55	E	10
SWPZ5555F	55/55	F	10
SWPZ6060A	60/60	A	10
SWPZ6060B	60/60	B	10
SWPZ6060C	60/60	C	10

\*Note: Combinations are consistent between all Siegware Euro Cylinders, Half Cylinders, and Thumb Turn Cylinders.



**Catalogue not up to date?**  
Scan the QR or [click here](#)  
to view the latest version

[Click to jump back to top](#)

## Siegware Euro Profile Cylinder - Anodised Black

Euro profile full cylinder with 6 pin locking system. The body is made from nickel plated solid brass. All pins are made of solid brass and include security driver pins. These cylinders also include antidrill inserts. Tested to 200,000 cycles and compliant with the EN1303:2005.

All cylinders include 3 brass keys and 1 fixing screw.



Product Code	Size (A / B)	Combination	Packaging unit
SWPZ3535A_BLK	35/35	A	10
SWPZ4040A_BLK	40/40	A	10
SWPZ4060A_BLK	40/60	A	10
SWPZ4550A_BLK	45/50	A	10
SWPZ5050A_BLK	50/50	A	10
SWPZ6060A_BLK	60/60	A	10

\*All cylinders include 3 brass keys and 1 fixing screw.



Catalogue not up to date?  
Scan the QR or [click here](#)  
to view the latest version

[Click to jump back to top](#)

## Siegware Custome Euro Profile Cylinder

Euro profile full cylinder with 6 pin locking system. The body is made from nickel plated solid brass. All pins are made of solid brass and include security driver pins. These cylinders also include anti drill inserts. Tested to 200,000 cycles and compliant with the EN1303:2005.

All cylinders include 3 brass keys and 1 fixing screw.

Custom pinned euro cylinders according to client specification. Please allow up to 5 business days production time.

Master keying is possible upon request. Please contact Siegware for further information.

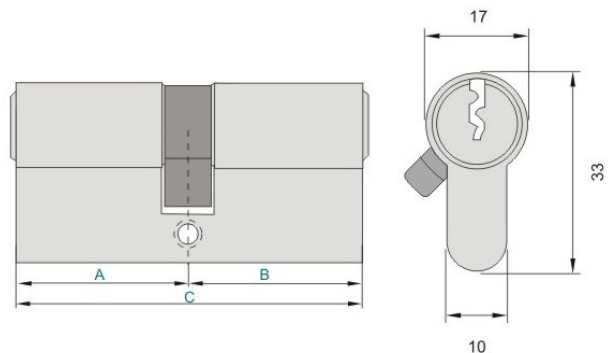

Product Code	Size (A / B)	Packaging Unit
SWPZ3535CUSTOM	35/35	1
SWPZ4040CUSTOM	40/40	1
SWPZ4055CUSTOM	40/55	1
SWPZ4060CUSTOM	40/60	1
SWPZ4070CUSTOM	40/70	1
SWPZ4545CUSTOM	45/45	1
SWPZ4550CUSTOM	45/50	1
SWPZ4560CUSTOM	45/60	1
SWPZ4570CUSTOM	45/70	1
SWPZ4575CUSTOM	45/75	1
SWPZ5050CUSTOM	50/50	1
SWPZ5555CUSTOM	55/55	1
SWPZ5560CUSTOM	55/60	1
SWPZ6060CUSTOM	60/60	1



Catalogue not up to date?  
Scan the QR or [click here](#)  
to view the latest version

[Click to jump back to top](#)

## Siegware Euro Thumb Turn Cylinder

Euro profile Thumb Turn cylinder with 6 pin locking system. The body is made from nickel plated solid brass. All pins are made of solid brass and include security driver pins. These cylinders also include antidrill inserts. Tested to 200,000 cycles and compliant with the EN1303:2005.

Note: Combinations are consistent between all Siegware Euro Cylinders, Half Cylinders, and Thumb Turn Cylinders.

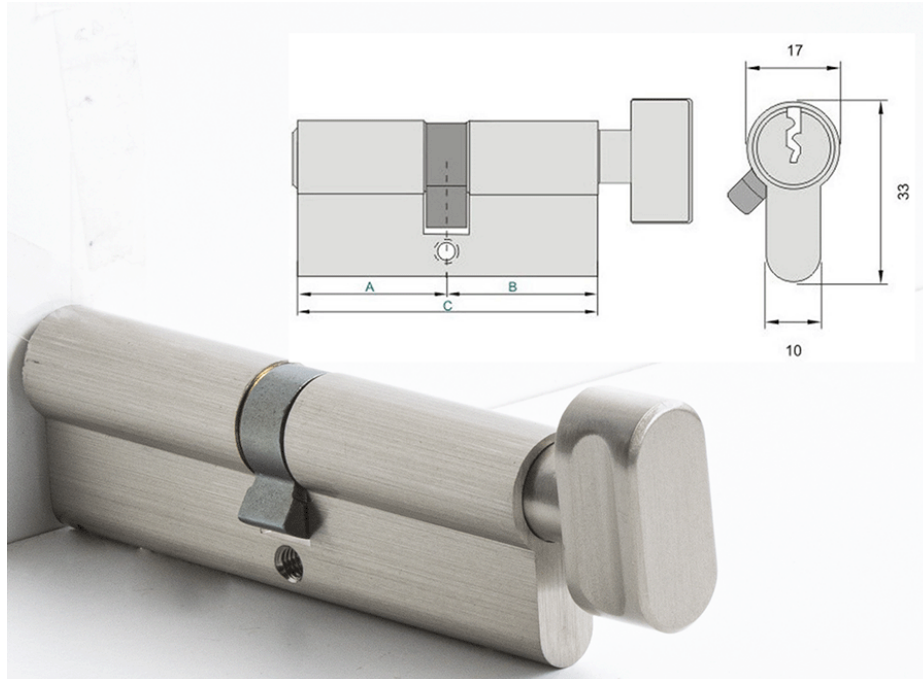

Product Code	Dim. A	Dim. B - Knob Side	Knob Depth	Combination	Packing unit
SWPZKB3535A	35mm	35mm	22mm	A	10
SWPZKB3535B	35mm	35mm	22mm	B	10
SWPZKB3535C	35mm	35mm	22mm	C	10
SWPZKB4040A	40mm	40mm	22mm	A	10
SWPZKB4040B	40mm	40mm	22mm	B	10
SWPZKB4040C	40mm	40mm	22mm	C	10
SWPZKB4060A	40mm	60mm	22mm	A	10
SWPZKB4060B	40mm	60mm	22mm	B	10
SWPZKB4060C	40mm	60mm	22mm	C	10
SWPZKB4545A	45mm	45mm	22mm	A	10
SWPZKB4545B	45mm	45mm	22mm	B	10
SWPZKB4545C	45mm	45mm	22mm	C	10
SWPZKB4550A	45mm	50mm	22mm	A	10
SWPZKB4550B	45mm	50mm	22mm	B	10
SWPZKB4550C	45mm	50mm	22mm	C	10

\*All cylinders include 3 brass keys and 1 fixing screw.



**Catalogue not up to date?**  
Scan the QR or [click here](#)  
to view the latest version

[Click to jump back to top](#)



## Siegware Euro Thumb Turn Cylinder - continue

Euro profile Thumb Turn cylinder with 6 pin locking system. The body is made from nickel plated solid brass. All pins are made of solid brass and include security driver pins. These cylinders also include antidrill inserts. Tested to 200,000 cycles and compliant with the EN1303:2005.

Note: Combinations are consistent between all Siegware Euro Cylinders, Half Cylinders, and Thumb Turn Cylinders.

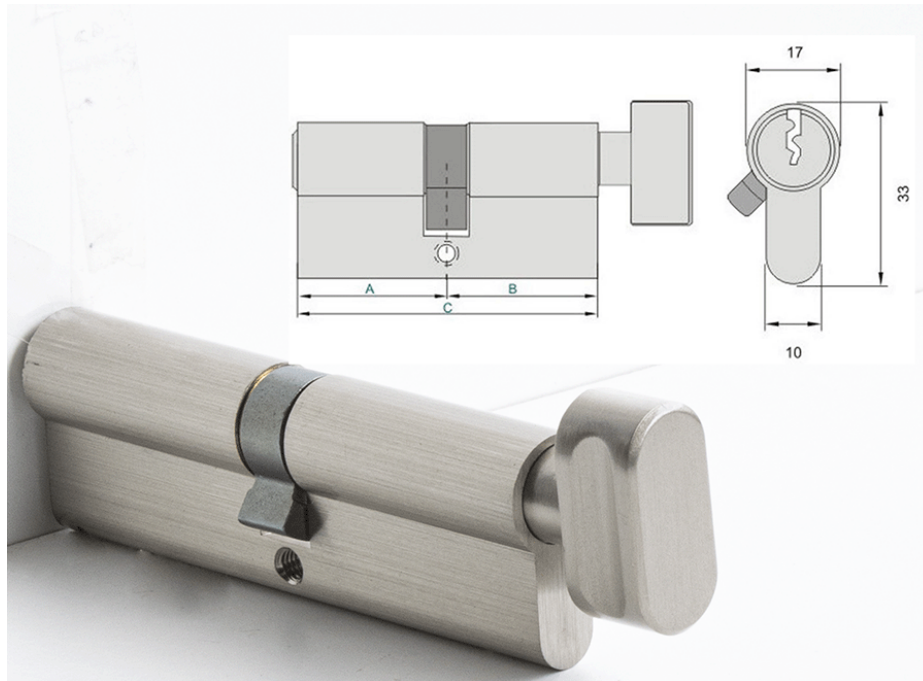

Product Code	Dim. A	Dim. B - Knob Side	Knob Depth	Combination	Packing unit
SWPZKB5045A	50mm	45mm	22mm	A	10
SWPZKB5045B	50mm	45mm	22mm	B	10
SWPZKB5045C	50mm	45mm	22mm	C	10
SWPZKB5050A	50mm	50mm	22mm	A	10
SWPZKB5050B	50mm	50mm	22mm	B	10
SWPZKB5050C	50mm	50mm	22mm	C	10
SWPZKB5555A	55mm	55mm	22mm	A	10
SWPZKB5555B	55mm	55mm	22mm	B	10
SWPZKB5555C	55mm	55mm	22mm	C	10
SWPZKB6040A	60mm	40mm	22mm	A	10
SWPZKB6040B	60mm	40mm	22mm	B	10
SWPZKB6040C	60mm	40mm	22mm	C	10
SWPZKB6060A	60mm	60mm	22mm	A	10
SWPZKB6060B	60mm	60mm	22mm	B	10
SWPZKB6060C	60mm	60mm	22mm	C	10

\*All cylinders include 3 brass keys and 1 fixing screw.



Catalogue not up to date?  
Scan the QR or [click here](#)  
to view the latest version

[Click to jump back to top](#)

## Siegware Euro Thumb Turn Cylinder - Anodised Black

Euro profile Thumb Turn cylinder with 6 pin locking system. The body is made from nickel plated solid brass. All pins are made of solid brass and include security driver pins. These cylinders also include antidrill inserts. Tested to 200,000 cycles and compliant with the EN1303:2005.

Note: Combinations are consistent between all Siegware Euro Cylinders, Half Cylinders, and Thumb Turn Cylinders.



Product Code	Dim. A	Dim. B - Knob Side	Knob Depth	Combination	Packing unit
SWPZKB3535A_BLK	35	35	22mm	A	10
SWPZKB3535B_BLK	35	35	22mm	B	10
SWPZKB4040A_BLK	40	40	22mm	A	10
SWPZKB4040B_BLK	40	40	22mm	B	10
SWPZKB4060A_BLK	40	60	22mm	A	10
SWPZKB4545A_BLK	45	45	22mm	A	10
SWPZKB4545B_BLK	45	45	22mm	B	10
SWPZKB5050A_BLK	50	50	22mm	A	10
SWPZKB5050B_BLK	50	50	22mm	B	10
SWPZKB5555A_BLK	55	55	22mm	A	10
SWPZKB5555B_BLK	55	55	22mm	B	10
SWPZKB6040A_BLK	60	40	22mm	A	10
SWPZKB6040B_BLK	60	40	22mm	B	10

\*All cylinders include 3 brass keys and 1 fixing screw.



Catalogue not up to date?  
Scan the QR or [click here](#)  
to view the latest version

[Click to jump back to top](#)

## Siegware Euro Half Cylinder

Euro profile half cylinder with 6 pin locking system. The body is made from nickel plated solid brass. All pins are made of solid brass and include security driver pins. These cylinders also include antidrill inserts. Tested to 200,000 cycles and compliant with the EN1303:2005.

All cylinders include 3 brass keys and 1 fixing screw.

Note: Combinations are consistent between all Siegware Euro Cylinders, Half Cylinders, and Thumb Turn Cylinders.

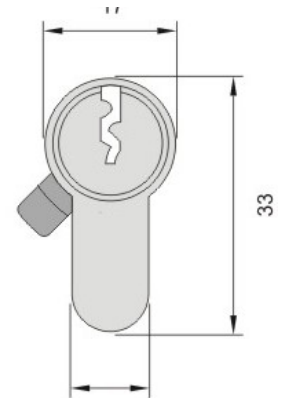
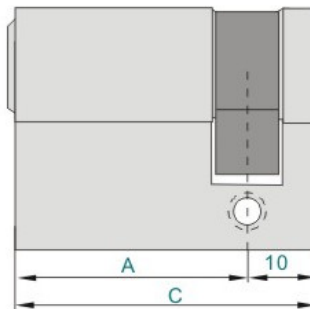

Product Code	Size	Dimension A	Dimension B	Combination	Packing unit
SWPZHALF350A	35/10	35mm	10mm	A	10
SWPZHALF350B	35/10	35mm	10mm	B	10
SWPZHALF400A	40/10	40mm	10mm	A	10
SWPZHALF400B	40/10	40mm	10mm	B	10
SWPZHALF500A	50/10	50mm	10mm	A	10
SWPZHALF500B	50/10	50mm	10mm	B	10
SWPZHALF500C	50/10	50mm	10mm	C	10
SWPZHALF500D	50/10	50mm	10mm	D	10
SWPZHALF500E	50/10	50mm	10mm	E	10
SWPZHALF500F	50/10	50mm	10mm	F	10
SWPZHALF550A	55/10	55mm	10mm	A	10
SWPZHALF550B	55/10	55mm	10mm	B	10
SWPZHALF550C	55/10	55mm	10mm	C	10
SWPZHALF550D	55/10	55mm	10mm	D	10
SWPZHALF550E	55/10	55mm	10mm	E	10
SWPZHALF550F	55/10	55mm	10mm	F	10
SWPZHALF600A	60/10	60mm	10mm	A	10
SWPZHALF600B	60/10	60mm	10mm	B	10
SWPZHALF600C	60/10	60mm	10mm	C	10



Catalogue not up to date?  
Scan the QR or [click here](#)  
to view the latest version

[Click to jump back to top](#)

Siegware Euro Half Cylinder - Anodised Black

Euro profile half cylinder with 6 pin locking system. The body is made from nickel plated solid brass. All pins are made of solid brass and include security driver pins. These cylinders also include antidrill inserts. Tested to 200,000 cycles and compliant with the EN1303:2005.

All cylinders include 3 brass keys and 1 fixing screw.

Note: Combinations are consistent between all Siegware Euro Cylindres, Half Cylinders, and Thumb Turn Cylinders.

**COMING  
SOON**

Product Code	Size	Combination	Packing unit
SWPZHALF350A_BLK	35/10	A	10
SWPZHALF500A_BLK	50/10	A	10
SWPZHALF550A_BLK	55/10	A	10



Catalogue not up to date?  
Scan the QR or [click here](#)  
to view the latest version

[Click to jump back to top](#)

## Siegware Euro Half Thumb Turn Cylinder

Euro profile half Thumb Turn cylinder. The body is made from nickel plated solid brass. This cylinder has no key and is actuated by knob only. Locking position can be felt via ball detent mechanism. Tested to 200,000 cycles and compliant with the EN1303:2005.



Product Code	Size	Dimension A	Knob Depth	Packing unit
SWPZKBHALF350	35/10	35mm	22mm	10
SWPZKBHALF400	40/10	40mm	22mm	10
SWPZKBHALF500	50/10	50mm	22mm	10
SWPZKBHALF550	55/10	55mm	22mm	10
SWPZKBHALF600	60/10	60mm	22mm	10



Catalogue not up to date?  
Scan the QR or [click here](#)  
to view the latest version

[Click to jump back to top](#)

## Siegware Euro Half Thumb Turn Cylinder - Anodised Black

Euro profile half Thumb Turn cylinder. The body is made from nickel plated solid brass. This cylinder has no key and is actuated by knob only. Locking position can be felt via ball detent mechanism. Tested to 200,000 cycles and compliant with the EN1303:2005.

**COMING  
SOON**

Product Code	Size	Dimension A	Knob Depth	Packing unit
SWPZKBHALF500_BLK	50/10	50	22mm	10
SWPZKBHALF550_BLK	55/10	55	22mm	10



Catalogue not up to date?  
Scan the QR or [click here](#)  
to view the latest version

[Click to jump back to top](#)



Siegware Snib Key

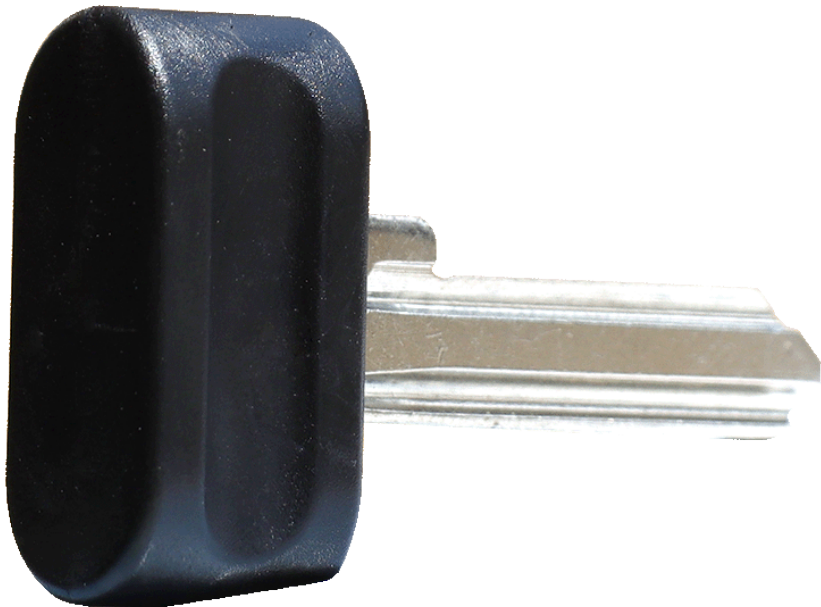

Product Code	Combination	Packaging unit
SWSNIB-BLANK	Blank	1
SWSNIB-A	A	1
SWSNIB-B	B	1
SWSNIB-C	C	1
SWSNIB-D	D	1
SWSNIB-E	E	1
SWSNIB-F	F	1



Catalogue not up to date?  
 Scan the QR or [click here](#)  
 to view the latest version

[Click to jump back to top](#)

Blind Profile Cylinder

The blind profile cylinder are made of nickel-plated brass and are used a blind cylidners for fittings with PZ perforation where no Euro Cylinder is fitted.

Suitable for fire and smoke protection doors.



Product Code	Range (mm)	Packaging unit
421748	47 - 120	1



Catalogue not up to date?  
Scan the QR or [click here](#)  
to view the latest version

[Click to jump back to top](#)



blaugelb Lock Cylinder Spray

The locking cylinder spray is the universal care product for locks and locking cylinders with a special, non-greasy formula. It protects against water, icing, corrosion and wear. Also suitable for other moving mechanical parts.



Product Code	Description	Size (mL)	Packaging unit
0370698	Cylinder spray	50	20



Catalogue not up to date?  
Scan the QR or [click here](#)  
to view the latest version

[Click to jump back to top](#)

## Medos Additional Rosette

Single additional rosette. Note: No installation screws included.

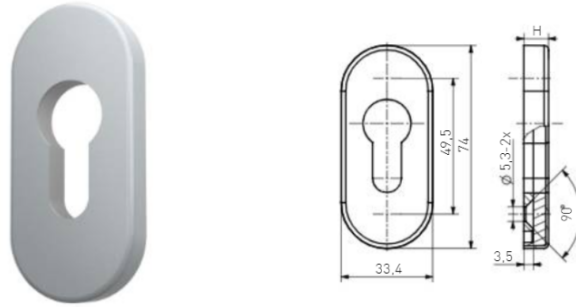

Product Code	Description	Rosette Thickness	Colour	Packaging unit
151INOX0000	Additional Rosette - Oval	9mm	Stainless Steel	1
15180770000	Additional Rosette - Oval	9mm	RAL8077	1
15190050000	Additional Rosette - Oval	9mm	RAL9005 Black	1
15190160000	Additional Rosette - Oval	9mm	RAL9016 White	1
1519005M0000	Additional Rosette - Oval	9mm	RAL9005 Black (Matt)	1
151SILV0000	Additional Rosette - Oval	9mm	Silver	1



**Catalogue not up to date?**  
Scan the QR or [click here](#)  
to view the latest version

[Click to jump back to top](#)

blaugelb External Round Escutcheon

Invisible fix round external escutcheon, screws included.

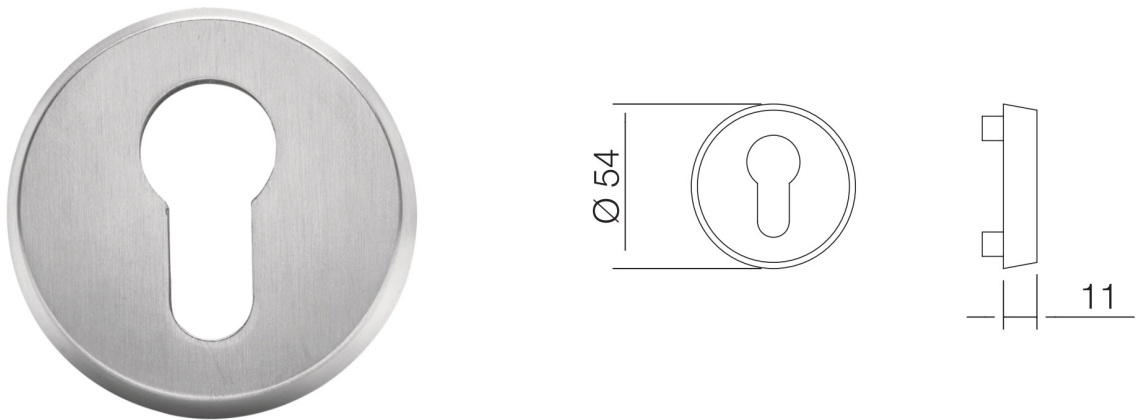

Product Code	Description	Width	Finish	Colour	Packaging unit
413771	Escutcheon PZ external round SS	54mm	stainless steel	fine matt	5



Catalogue not up to date?  
Scan the QR or [click here](#)  
to view the latest version

[Click to jump back to top](#)

blaugelb Internal Oval Escutcheon

Invisible fix oval internal escutcheon, screws not included.

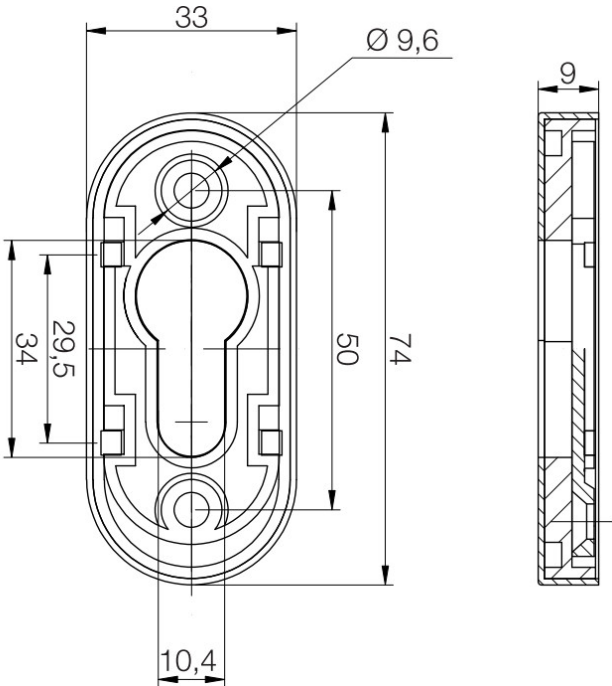

Product Code	Description	Length	Finish	Colour	Packaging unit
417611	Escutcheon PZ internal oval SS	74mm	stainless steel	fine matt	20



Catalogue not up to date?  
Scan the QR or [click here](#)  
to view the latest version

[Click to jump back to top](#)

### 35mm Escutcheon ER

Ornamental escutcheon ring for recessed mounting of cylinder. Self adhesive backing. To fit standard euro profile cylinders.

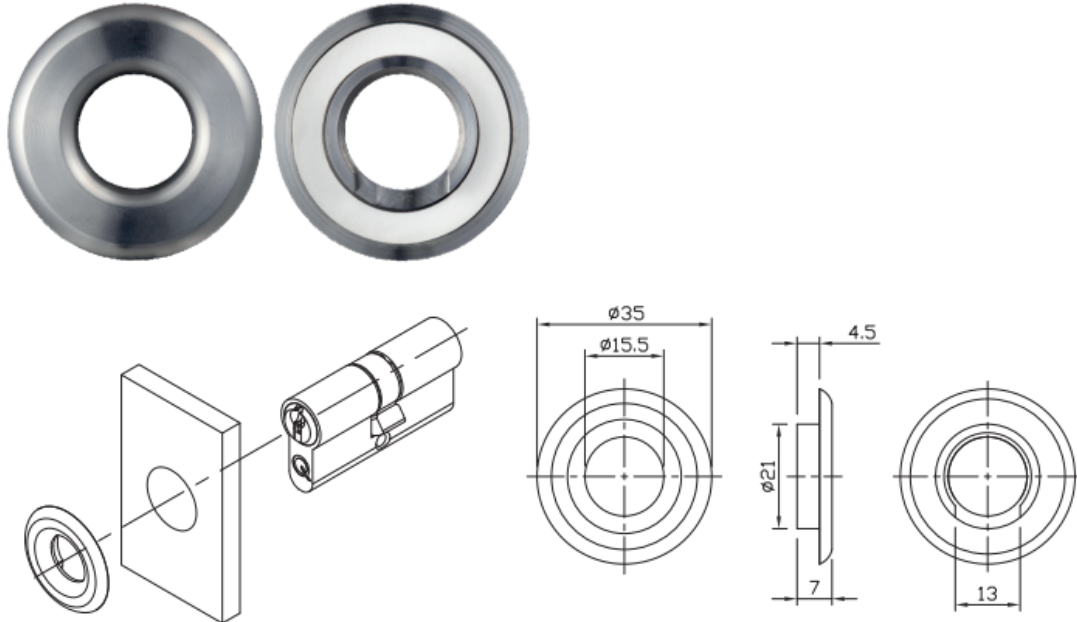

Product Code	Description	Finish	Colour	Packaging unit
GTWC25ESC	25mm Escutcheon	Fine Matt Brushed	Stainless Steel	15
GTWC35ESC	35mm Escutcheon	Fine Matt Brushed	Stainless Steel	15



**Catalogue not up to date?**  
Scan the QR or [click here](#)  
to view the latest version

[Click to jump back to top](#)

## Medos Additional Rosette Set – Square

Square additional rosette set. Includes inside and outside rosette and mounting screws.

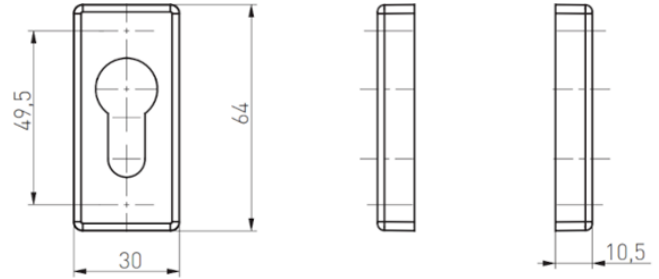

Product Code	Description	Rosette Thickness	Colour	Packaging unit
150D9005M	Additional Rosette - Square	10.5mm	RAL9005 Black (Matt)	1 pair
150D9016M	Additional Rosette - Square	10.5mm	RAL9016 White	1 pair
150DF1SD	Additional Rosette - Square	10.5mm	F1 Silver	1 pair
150DF6BD	Additional Rosette - Square	10.5mm	F6 Stainless	1 pair



**Catalogue not up to date?**  
Scan the QR or [click here](#)  
to view the latest version

[Click to jump back to top](#)

Siegware Spare Escutcheon Set

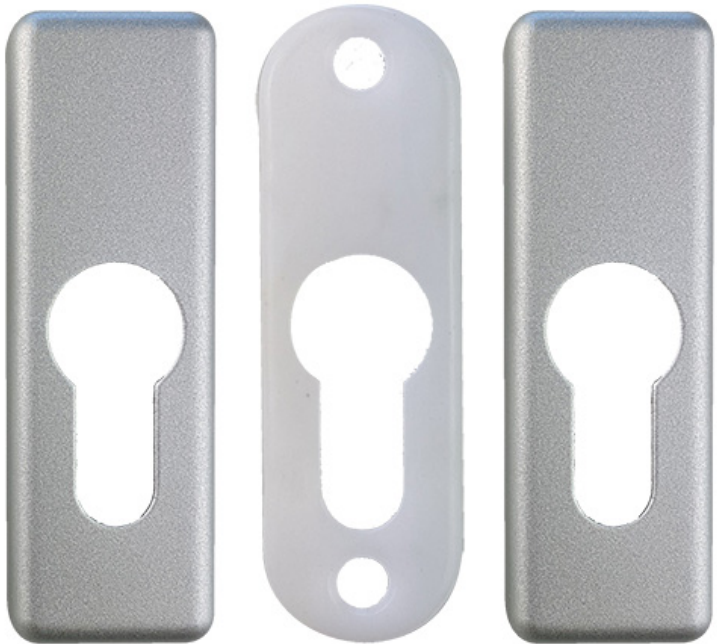

Product Code	Description	Finish	Colour	Packaging unit
SWSLESSIL	Spare Parts: Escutcheon set	anodised	F1 Silver	1 set
SWSLESWHT	Spare Parts: Escutcheon set	coated	9016 white	1 set
SWSLESBLK	Spare Parts: Escutcheon set	coated	9005 black	1 set



**Catalogue not up to date?**  
 Scan the QR or [click here](#)  
 to view the latest version

[Click to jump back to top](#)

## Lock Cylinders Catalogue

*53 Haddon Drive  
PO Box 27  
Ballan VIC 3342  
Australia*

*+61 03 5368 1181  
info@siegware.com.au  
www.siegware.com.au  
www.siegware.co.nz*